

E M C O



## Bollards

In a low level lighting environment, a luminaire must address not only specific lighting criteria, but more importantly, the issues of vandalism, durability, and ease of maintenance.

EMCO's design philosophy exhibits an understanding and solution to these issues. In our line of bollards, you will find such features as seamless extruded housings, tamper resistant hardware, and silicone seals and gaskets to assure years of trouble-free operation. By using basic geometric forms that blend well into the landscape, matched with a wide variety of optical systems, EMCO can provide a specific bollard to fit your particular project.

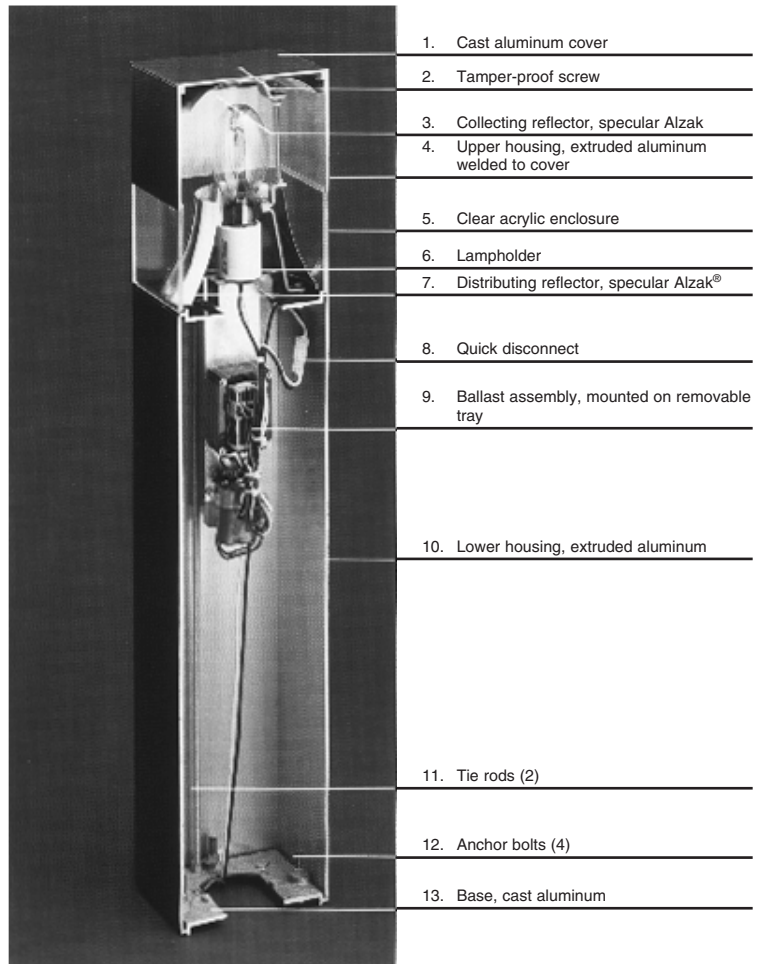

## Optical Systems

Round

Square

C

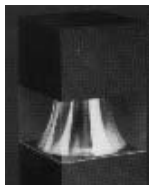

R

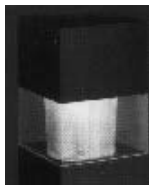

S

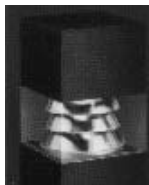

L



Cross Section

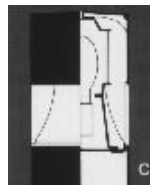

**Round Reflector** is cone-shaped specular Alzak® to project light outward in a 360° circle below eye level. Collecting reflector conceals light source and directs illumination to distributing Alzak® reflector. A clear acrylic window seals unit.

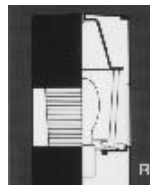

**Prismatic Glass Refractor** diffuses light and distributes it outward and downward with Type V distribution. Assembly is protected from the weather and vandals by a clear acrylic shield.

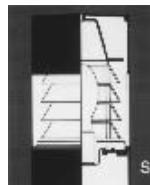

**Round Polished Aluminum Louvers** hide light source and direct light downward in a 360° circular pattern. A clear acrylic shield protects the system.

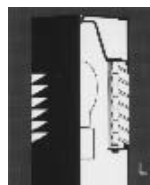

**Cast Louvers** conceal the light source while directing illumination outward and downward. Finished to match fixture. Glass cylinder mounted inside protects the lamp.

# Photometrics

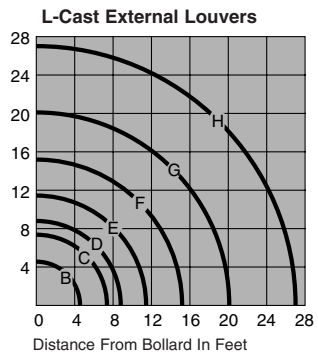
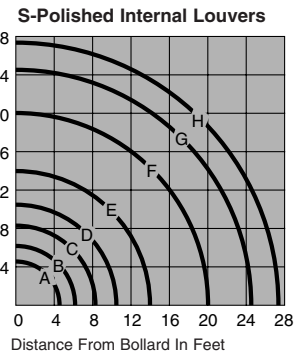
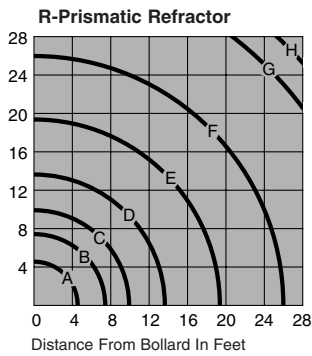
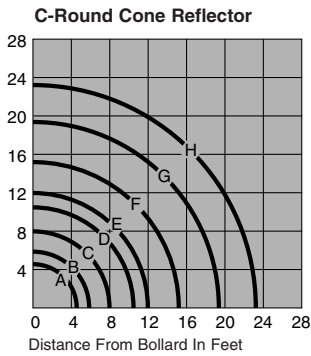

Initial footcandles for 100W HPS  
42" bollard (center of optics 36"  
above grade).

Curve	F.C. Values
A	10.0
B	5.0
C	2.0
D	1.0
E	.50
F	.20
G	.10
H	.05

**Lamp Factor Table**

Lamp	Factor
50W HPS	.42
70W HPS	.66
100W HPS	1.00
150W HPS*	1.68
50W MH	.36
70W MH	.53
100W MH	.89
150W MH*	1.47

\*L style only

For approximate f.c. levels, the factors shown  
may be multiplied by the 100W HPS value.  
Ex: 70W HPS at C curve  
= .66 x 2.0 = 1.32 f.c.

# Dimensions & Mounting Detail

## BR8, BS8 SERIES

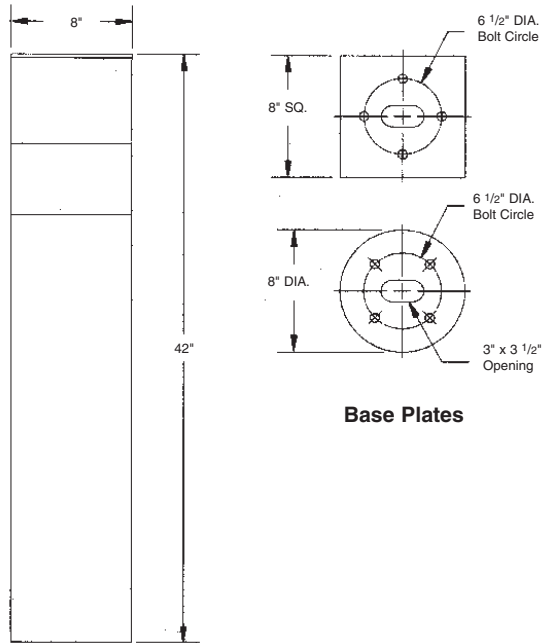

Note: Factory supplied template must be used when setting anchor bolts. EMCO Lighting will not honor any claim for incorrect anchorage placement from failure to use factory supplied templates.

# Specifications

## UPPER HOUSING

Extruded aluminum sides are welded to cast aluminum top and secured with single pin-in-head socket tamper-resistant screw.

## LOWER HOUSING

One-piece seamless extruded aluminum.

## LENS

*BR8* - one-piece 1/4" extruded clear virgin acrylic.

*BS8* - Four sections of 5/16" mitered clear virgin acrylic are chemically bonded.

## OPTICAL SYSTEMS

(C) *Cone* - Upper collecting and lower distributing Alzak® aluminum reflectors provide efficient distribution of light.

(R) *Reflector* - Prismatic borosilicate glass designed to direct light outward and downward.

(S) *Polished Aluminum Louvers* - Angled to provide maximum spacings while shielding the light source.

(L) *Cast Louvers* - Individually cast aluminum blades are fastened in a unitized assembly.

## ANCHORAGE

Cast aluminum base is secured to the mounting

foundation with four (4) 3/8" x 9" anchor bolts on a 6 1/2" bolt circle. Two (2) threaded 3/8" tie rods internally secure the housing to the anchor base.

## ELECTRICAL

Standard medium base lampholder is glazed porcelain with a nickel-plated reinforced screwshell and spring loaded contact. The ballast and lampholder are prewired with quick electrical disconnects and mounted on a one-piece assembly secured internally to the lower housing with two (2) captive screws.

Each high power factor ballast is the separate component type, capable of providing reliable lamp starting down to -20° F. Component-to-component wiring within the luminaire will carry no more than 80% of rated current and is listed by UL for use at 600 VAC, 15A or higher. Plug disconnects are listed by UL for use at 600 VAC, 15A or higher.

## FINISH

Each luminaire receives a fade and abrasion resistant electrostatically applied, thermally cured textured polyester powdercoat finish.

## LABELS

All fixtures bear UL or CUL (where applicable) wet location labels.

*EMCO Lighting reserves the right to change materials or modify the design of its product without notification as part of the company's continuing product improvement program.*



# Ordering

## O R D E R I N G

PREFIX	OPTICS	WATTAGE	VOLTAGE	FINISH	OPTIONS
<b>BR8</b>	<b>L</b>	<b>100MH</b>	<b>120</b>	<b>BLP</b>	<b>PCB</b>
<b>BS8</b> Square <b>BR8</b> Round	<b>C</b> Cone Round Reflector <b>R</b> Reflector <b>S</b> Polished Louvers <b>L</b> Cast Louvers	<b>50HPS</b> <b>70HPS</b> <b>100HPS</b> <b>50MH</b> <b>70MH</b> <b>100MH</b>  <i>Cast Louver (L) Optics Only</i> <b>150HPS</b> <b>150MH</b>	<b>120</b> <b>277</b>	<b>BLP</b> Black Paint <b>BRP</b> Bronze Paint <b>NP</b> Natural Aluminum Paint <b>WP</b> White Paint <b>OC</b> Optional Color Paint <i>Specify RAL designation ex: OC-RAL7024</i> <b>SC</b> Special Color Paint <i>Must supply color chip</i>	<b>HS-180</b> 180° House Side Shield <b>PCB</b> Button Photocontrol <b>30</b> 30" High ( <i>standard height is 42"</i> ) <b>36</b> 36" High ( <i>standard height is 42"</i> ) <b>F</b> Fusing <b>GFCI</b> GFCI Receptacle <i>(weathertight, flush-mounted in lower housing)</i>

**Note: Factory supplied template must be used when setting anchor bolts. EMCO Lighting will not honor any claim for incorrect anchorage placement from failure to use factory supplied templates**

**Consult Submittal Data Sheets on [www.sitelighting.com](http://www.sitelighting.com) for most current information prior to ordering.**