

Job:
 Type:
 Notes:

Featuring CosmoPolis and MasterColor Elite Electronic HID Systems

Form 10 Square

Page 1 of 3

Wall Mount

The Gardco wall mounted Square Form 10 products are cutoff luminaires for high intensity discharge lamps up to 400 watts. BE and WE units are manufactured from mitered extruded aluminum and finished in an Architectural Class 1 anodizing. The BH and WH luminaires are die formed aluminum with a thermoset polyester finish. Both products can accept one of four (4) interchangeable and rotatable precision segmented optical systems.

Flat glass lens luminaires provide full cutoff performance. Sag Lens luminaires provide cutoff performance.

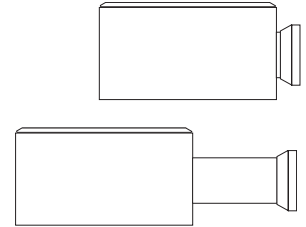

PREFIX	MOUNTING	DISTRIBUTION	WATTAGE	VOLTAGE	FINISH	OPTIONS
<input type="text"/>	<input type="text"/>	<input type="text"/>	<input type="text"/>	<input type="text"/>	<input type="text"/>	<input type="text"/>

Enter the order code into the appropriate box above. Note: Gardco reserves the right to refuse a configuration. Not all combinations and configurations are valid. Refer to notes below for exclusions and limitations. For questions or concerns, please consult the factory.

PREFIX

With Arm	Without Arm	
BE14	WE14	14" Square Extruded Luminaire
BE19	WE19	19" Square Extruded Luminaire
BH14	WH14	14" Square Fabricated Luminaire
BH19	WH19	19" Square Fabricated Luminaire

MOUNTING

1 Single Assembly

DISTRIBUTION

1	Type 1	1. 19" luminaires only, supplied with flat glass lens standard. 2. MH/PSMH 400W Type 4X luminaires require the E28/BT28 reduced jacket lamp.
3	Type 1ll	
4X^{1,2}	Type	
FM	Type 1V	

WATTAGE

	14"	19"
Pulse Start MH Magnetic Ballast	100MH³ 150MH³ 175PSMH[ⓔ] 200MH[ⓔ]	250PSMH[ⓔ] 250PS90**[ⓔ] 320PSMH[ⓔ] 350PSMH[ⓔ] 400PSMH²[ⓔ]
CosmoPolis™ Electronic System (See Notes 4, 5, 7)	60CMPE 90CMPE 140CMPE	
MasterColor® Elite Electronic System (See Notes 4, 5, 7, 8)		210MCE-3K[ⓔ] 210MCE-4K[ⓔ] 315MCE-3K[ⓔ] 315MCE-4K[ⓔ]
Pulse Start MH Electronic Ballast		250PSE^{4,5}[ⓔ] 320PSE^{4,5,6}[ⓔ]
Standard (probe start) MH Magnetic Ballast*	175MH* 250MH*	250MH* 400MH*²
High Pressure Sodium Magnetic Ballast	70HPS 100HPS 150HPS	200HPS 250HPS 400HPS

VOLTAGE

120	200-277
208	CMPE, MCE and PSE types only.
240	
277	QUAD
347	120/208/240/277
480	wired to 277V.

- MH/PSMH 400W Type 4X luminaires require the E28/BT28 reduced jacket lamp.
- Medium base lamp.
- UL Listed at 40°C ambient.
- Available 120V, 200-277V, 347V or 480V only.
- Requires E28/BT28 lamp.
- CosmoPolis and MasterColor Elite systems are supplied with lamp.
- "-3K" suffix specifies a 3000°K lamp and "-4K" suffix specifies a 4000°K lamp.

* 175W, 250W and 400W probe start MH luminaires are not available for sale in the United States.
 ** 250PS90 includes a 90% efficient magnetic PSMH ballast, meeting the requirements of California Title 20, effective 1/1/2010.

(E) Wattages marked with Circle "E" meet federal energy efficiency standards applicable to 150 watt through 500 watt metal halide luminaires only.

1611 Clovis Barker Road, San Marcos, TX 78666
 (800) 227-0758 (512) 753-1000 FAX: (512) 753-7855 sitelighting.com

© 2010 Koninklijke Philips Electronics N.V. All Rights Reserved.

Philips Gardco reserves the right to change materials or modify the design of its product without notification as part of the company's continuing product improvement program.

79115-44/1010

PHILIPS

GARDCO

FINISH

Extruded Luminaires

- BRA** Bronze Anodized
- BLA** Black Anodized
- NA** Natural Anodized
- OC** Optional Color Paint
Specify Optional Color or RAL ex: OC-LGP or OC-RAL7024.
- SC** Special Paint
Specify. Must supply color chip.

Fabricated Luminaires

- BRP** Bronze Paint
- BLP** Black Paint
- OC** Optional Color Paint
Specify Optional Color or RAL ex: OC-LGP or OC-RAL7024.
- SC** Special Paint
Specify. Must supply color chip.

OPTIONS

- | | |
|--|--|
| F⁹ Fusing In Head | L6¹⁵ LumiStep Ballast 6 hour |
| PC⁹ Photocontrol and Receptacle | L8¹⁵ LumiStep Ballast 8 hour |
| PCR Photocontrol Receptacle only | L10¹⁵ LumiStep Ballast 10 hour |
| POLY¹⁰ Polycarbonate Sag Lens | |
| HS¹¹ Internal Houseside Shield | |
| QS¹² Quartz Standby | |
| QST¹² Quartz Standby - Timed Delay | |
| Q924¹² Quartz Emergency | |
| QT924¹² Quartz Emergency - Timed Delay | |
| XF¹³ Extended Flat Glass Lens | |
| SG¹⁴ Sag Glass Lens | |
| CD Clear Drop Diffuser <i>Extruded housings only.</i> | |
| UB Quick Disconnect for Ballast Tray | |

- 9. Not available in 480V. Specific input voltage required.
- 10. In lieu of flat glass. Not available with 4X optics. 400W maximum. Polycarbonate lenses carry 1 year warranty only.
- 11. Supplied standard with FM optics.
- 12. See QS/Q924 Table.
- 13. Flat Glass lens with extended drop. Available with 19" housings only.
- 14. In lieu of flat glass.
- 15. Available with CosmoPolis system only. See submittal sheet GE200-005 for complete information on LumiStep ballasts.

(Note 12) QS / Q924 Table	
HID Lamp Watts	Maximum Quartz Lamp Watts
175 watts or less	100 Watts
Above 175 watts up to 400 watts	150 Watts
14" luminaires limited to 100 watt quartz lamp maximum regardless of HID wattage.	

DIMENSIONS AND EPA

BE/BH

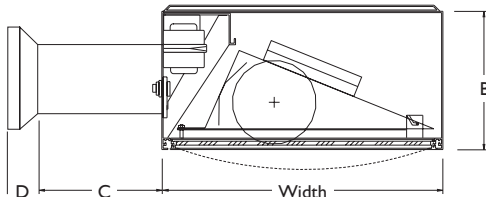

Size	Width	B	C	D
14	14"	7"	6"	2"
	35.56 cm	17.78 cm	15.24 cm	5.08 cm
19	19"	10"	9"	2"
	48.26 cm	25.40 cm	22.86 cm	5.08 cm

WE/WH

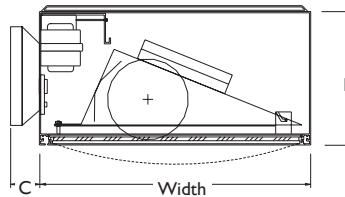

Size	Width	B	C
14	14"	7"	2"
	35.56 cm	17.78 cm	5.08 cm
19	19"	10"	2"
	48.26 cm	25.40 cm	5.08 cm

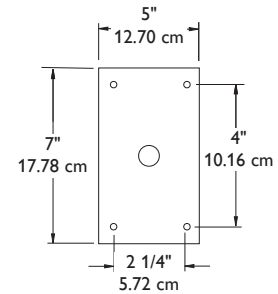

Wall Mounting Dimensions

SPECIFICATIONS

GENERAL: Each Gardco Square Form Ten wall mount is a cutoff luminaire for high intensity discharge lamps. Direct mount (WE and WH) and arm mounted (BE and BH) styles are offered. Internal components are totally enclosed, rain-tight, dust-tight and corrosion resistant. No venting of optical system or electrical components is required or permitted. Luminaires are completely assembled with no disassembly required for installation. Lamping requires no lifting or hinging the luminaire housing, disturbing wiring or exposing uninsulated live parts.

HOUSING: Extruded housings (WE and BE styles) are composed of precisely mitered anodized aluminum extrusions. Fabricated (WH and BH styles) units are one piece, multi-formed aluminum with an integral reinforcing spline and a single concealed joint. All units feature a press formed aluminum top which is welded to the housing sides. Pressure injected silicone provides a continuous weathertight seal at all miters and points of material transition.

WALL BRACKETS: All models include hooking die cast aluminum wall bracket that conceals 10 gauge mounting plate. BE and BH series include extruded arm to extend unit from wall.

LENS: Mitered, extruded anodized aluminum door frame retains the optically clear, heat and impact resistant tempered flat glass in a sealed manner using hollow section, high compliance, memory retentive extruded silicone rubber. Concealed stainless steel latch and hinge permit easy toolless access to the luminaire.

OPTICAL SYSTEMS: The segmented Form Ten optical system is homogeneous sheet aluminum, electrochemically brightened, anodized and sealed. The segmented reflectors are set in faceted arc tube image duplicator patterns to achieve IES Types I (1), III (3) and IV (FM and 4X) distributions. The mogul base lampholder is glazed porcelain with a nickel plated screw shell with lamp grip-all securely attached to the reflector assembly. 100 MH units have medium base lampholder. All Metal Halide units in the 19" housings have lamp stabilizers ensuring precise arc tube positioning.

ELECTRICAL: All electrical components are UL recognized and factory tested. Electronic and magnetic HID ballasts are high power factor and mounted on a unitized plate. Magnetic HID ballasts are the separate component type. Electronic and magnetic HID ballasts are capable of providing reliable lamp starting down to -20°F / -29°C.

Luminaires provided with the CosmoPolis or MasterColor Elite high performance ceramic metal halide electronic systems include high power factor electronic ballasts, designed specifically for the system selected.

FINISH: Extruded housings (WE and BE styles) are standard with natural, bronze, or black Aluminum Association Architectural Class I anodized finish applied after fabrication. Special color polyurethane finishes are available.

Formed housings (WH and BH styles) are standard with a chromate acid pretreatment and an epoxy undercoat. The finish coat is a thermosetting polyester baked at 450°F/232°C to achieve an H-2H hardness measure.

LABELS: All luminaires bear UL or CUL (where applicable) Wet Location labels.

WARRANTY: Gardco luminaires feature a 5 year limited warranty. See Warranty Information on www.sitelighting.com for complete details and exclusions. Polycarbonate lenses carry a 1 year warranty only.

FULL CUTOFF PERFORMANCE: Full cutoff performance means a luminaire distribution where zero candela intensity occurs at an angle at or above 90° above nadir. Additionally, the candela per 1000 lamp lumens does not numerically exceed 100 (10 percent) at a vertical angle of 80° above nadir. This applies to all lateral angles around the luminaire.

CUTOFF PERFORMANCE: Cutoff performance means a luminaire distribution where the candela per 1000 lamp lumens does not numerically exceed 25 (2.5 percent) at an angle at or above 90° above nadir, and 100 (10 percent) at a vertical angle of 80° above nadir. This applies to all lateral angles around the luminaire.

1611 Clovis Barker Road, San Marcos, TX 78666

(800) 227-0758 (512) 753-1000 FAX: (512) 753-7855 [sitelighting.com](http://www.sitelighting.com)

© 2012 Koninklijke Philips Electronics N.V. All Rights Reserved.

Philips Gardco reserves the right to change materials or modify the design of its product without notification as part of the company's continuing product improvement program.

79115-44/0512

PHILIPS

